

Weatherford

County: Parker

Weatherford Economic Development Department

(817) 598-4279 | kpegues@weatherfordtx.gov

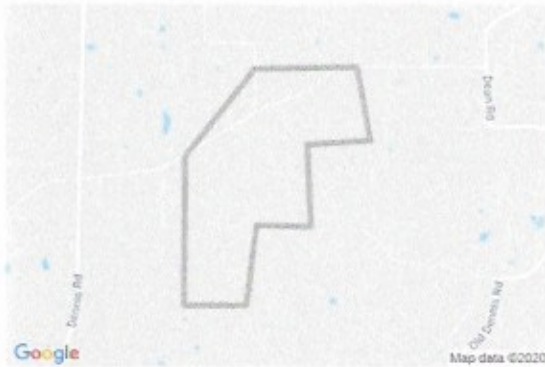

Source: ESRI[®], 2019

Population

Population Overview

Population 2019:	29,950
Population 2023:	31,278
Female Population 2019:	15,401
Male Population 2019:	14,548
Diversity Index:	42.5

Population By Race

White:	88%
Hispanic or Latino:	16%
Some Other Race:	5%
Two or More Races:	2%
Black or African American:	2%
Asian:	1%
American Indian:	1%
Native Hawaiian or Pacific Islander:	Below 1%

Workforce

Total Workforce:	14,522
Employed:	96%
Unemployed:	4%

Population By Age 2019

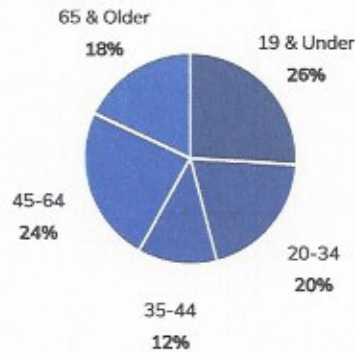

Population By Age 2023

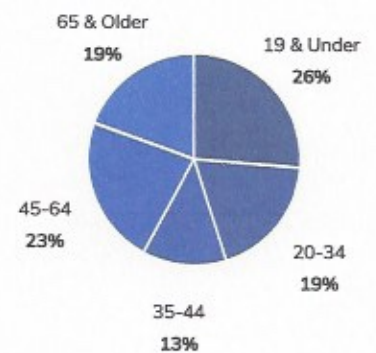

Age & Gender 2019

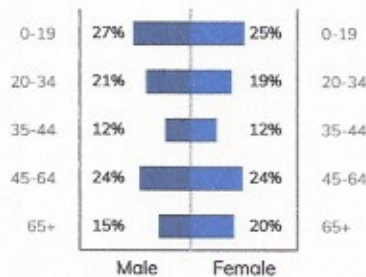

Median Age 2019



Households



Total Families



Average Daily Commute



Net Migration



Housing Overview

2019 Median Home Value:	\$181,830
2023 Median Home Value:	\$209,201
2019 Total Housing Units:	12,397
2019 Owner Occupied Units:	7,745
2019 Renter Occupied Units:	3,729
2019 Vacant Units:	924
2023 Total Housing Units:	12,944
2023 Owner Occupied Units:	8,123
2023 Renter Occupied Units:	3,729
2023 Vacant Units:	961

Employment by Industry

Health Care/Social Assistance:	1,701
Retail Trade:	1,552
Manufacturing:	1,487
Educational Services:	1,294
Construction:	1,231
Accommodation/Food Services:	1,168
Other Services:	1,061
Transportation/Warehousing:	749
Public Administration:	685
Professional/Scientific/Tech Services:	527
Admin/Support/Waste Management Services:	430
Finance/Insurance:	389
Real Estate/Rental/Leasing:	345
Mining/Quarrying/Oil & Gas Extraction:	342
Wholesale Trade:	286
Information:	228
Arts/Entertainment/Recreation:	192
Utilities:	171
Agriculture/Forestry/Fishing/Hunting:	162
Management of Companies/Enterprises:	9

Income

Median Household Income



Average Household Income



Per Capita Income



Income Growth

Per Capita Income Annual Growth Rate	2.48%
Median Household Income Annual Growth Rate	2.27%

Household Income Distribution

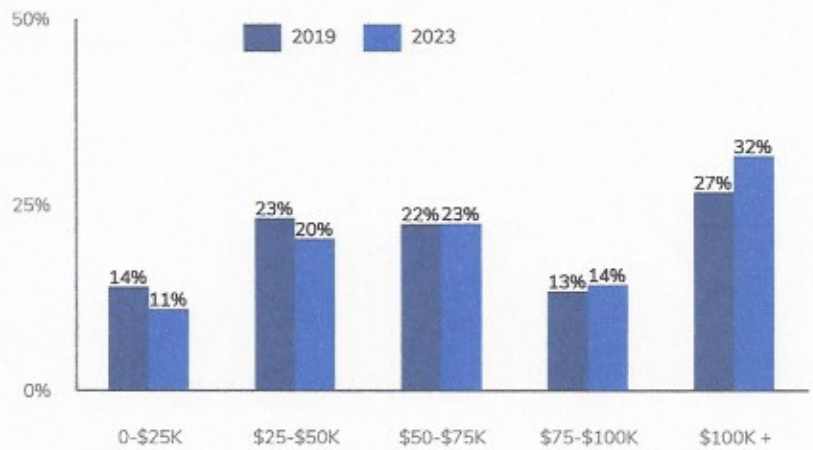

Education

Education Levels

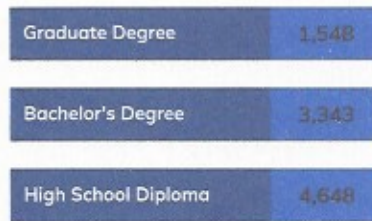

Education Attainment 2019

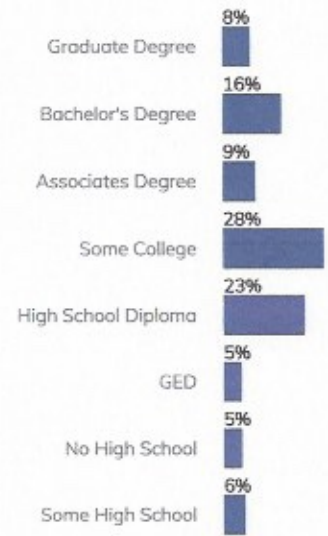

Source: ESRI®, 2019